

**ACCESSORIES AVAILABLE  
ACCESORIOS DISPONIBLES  
ACCESSOIRES DISPONIBLES**

- BC601 4 oz. Bostitch Air -Tool Lubricant
- BC602 1 pint Bostitch Air -Tool Lubricant
- BC603 1 pint Bostitch "Winter-Formula" Air-Tool Lubricant
- BC604 1 quart Bostitch Air -Tool Lubricant
- 851385 Loctite Grade 242 (.02 oz.)
- N80K2 Remote Control Kit
- 121072 Softfoot
- 112630 Dust Shield
- 112631 Spring Clip for Dust Shield
- N89ORKit, O-ring Repair

# BOSTITCH®

## F33PT

**PNEUMATIC STICK NAILERS  
CLAVADORA NEUMÁTICA ALIMENTADA POR BARRA  
CLOUEUR PNEUMATIQUE EN BANDES**

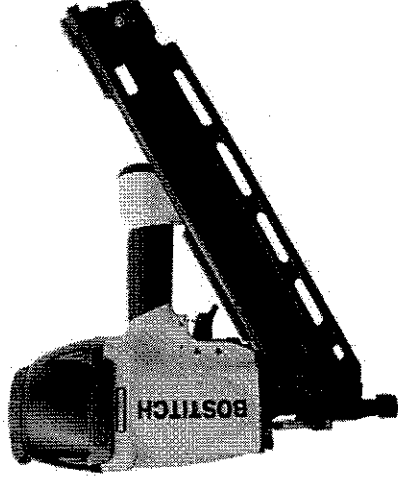

**TOOL PARTS ILLUSTRATION  
ILUSTRACIÓN DE LAS PIEZAS DE LA HERRAMIENTA  
ILLUSTRATION DES PIÈCES D'OUTILLAGE**

**⚠ WARNING:**

BEFORE PERFORMING REPAIRS ON THIS TOOL, ALL OPERATORS SHOULD STUDY THIS ILLUSTRATION, AS WELL AS THE PARTS LIST AND OPERATION AND MAINTENANCE MANUAL. OPERATORS SHOULD UNDERSTAND AND FOLLOW ALL SAFETY WARNINGS AND INSTRUCTIONS. KEEP THIS ILLUSTRATION WITH THE TOOL FOR FUTURE REFERENCE. IF YOU HAVE ANY QUESTIONS, CONTACT YOUR BOSTITCH REPRESENTATIVE OR DISTRIBUTOR.

**⚠ ADVERTENCIA:**

ANTES DE LLEVAR A CABO CUALQUIER REPARACIÓN EN LA HERRAMIENTA, TODOS LOS OPERARIOS DEBERÁN ESTUDIAR ESTA ILLUSTRACIÓN, ASÍ COMO LA LISTA DE PIEZAS Y EL MANUAL DE OPERACIÓN Y MANTENIMIENTO. LOS OPERARIOS DEBERÁN ENTENDER Y SEGUIR TODAS LAS ADVERTENCIAS E INSTRUCCIONES DE SEGURIDAD. CONSERVE ESTA ILLUSTRACIÓN CON LA HERRAMIENTA PARA PODER CONSULTARLA EN LO FUTURO. SI TUVIERA ALGUNA PREGUNTA, PONGASE EN CONTACTO CON SU REPRESENTANTE O DISTRIBUIDOR DE BOSTITCH.

AVANT DE PROCÉDER À LA RÉPARATION DE CET OUTIL, LES OPÉRATEURS DOIVENT ÉTUDIER LA PRÉSENTE ILLUSTRATION AINSI QUE LA LISTE DE PIÈCES ET LE MANUEL D'INSTRUCTIONS ET D'ENTRETIEN. ILS DOIVENT ÉGALEMENT COMPRENDRE ET OBSERVER LES CONSIGNES DE SÉCURITÉ ET LES INSTRUCTIONS. CONSERVER CETTE ILLUSTRATION AVEC L'OUTIL POUR RÉFÉRENCE FUTURE. SI VOUS AVEZ DES QUESTIONS, COMMUNIQUEZ AVEC VOTRE REPRÉSENTANT OU VOTRE DISTRIBUTEUR DE BOSTITCH.

IP1207-1REVE 05/06

**BOSTITCH**  
Stanley Fastening Systems L.P.

# F33PT

**PNEUMATIC STICK NAILERS**  
**CLAVADORA NEUMÁTICA ALIMENTADA POR BARRA**  
**CLOUEUR PNEUMATIQUE EN BANDES**

See reverse side for available accessories (not included)

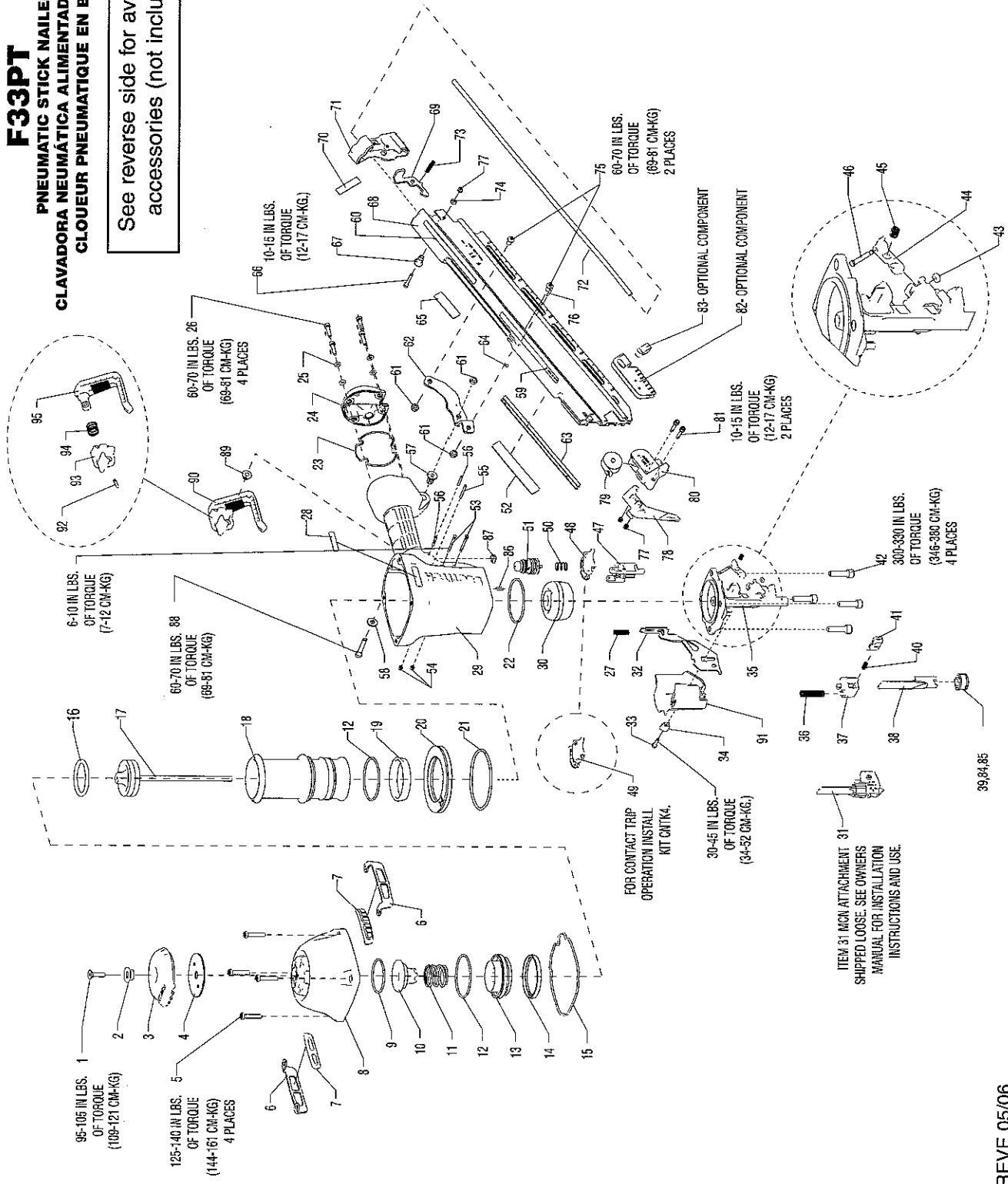

IP1207-1REVE 05/06  
 TO BE USED WITH PARTS LIST IP1207-2 AND OPERATION AND MAINTENANCE MANUAL 166762

## BOSTITCH

F33PT		Parts List: IP1207-2REVM			
		<b>To be Used with tool parts illustration:</b>		IP1207-1REVE	
		<b>and operation and maintenance manual:</b>		166762	
		<b>Serial Number on the Tool:</b>		<b>F33PT 7009 000 and Higher</b>	
ITEM	PART #	DESCRIPTION	ITEM	PART #	DESCRIPTION
1	MSF6100-25	SCREW,SFHCS,M6X1.00X25	54	MHE3050-100	NUT,NYLON M3X.50
2	163859	BUSHING,EXHAUST DEFLECTOR	55	100298	PIN,SPIRAL M3X30
3	163818	DEFLECTOR,EXHAUST	56	MPP030020	PIN,SPIRAL M3X20MM
4	163830	PLATE,CAP	57	123859	BUSHING,FLANGED ISOLATION
5	MSC6100-30	SCREW,SHCS,M6X1.00X30	58	MPW6.2	WASHER,SPECIAL
6	163827	PLATE,WEAR	59	158612	LABEL,WARNING
7	149819	WEAR GUIDE	60	163926	LABEL,FASTENER SPEC.MCN
8	163848	FRAME CAP,MACHINING	61	MHE6100-100	NUT,ESN M6X1
9	105814	O-RING,1.929X.098	62	166776	BRACKET,MAGAZINE
10	163820	BUMPER,HEAD VALVE	63	163904	LINER,NAIL GUIDE
11	163844	SPRING,HEAD VALVE	64	166797	O-RING,.056X.060 NBR
12	163822	O-RING,2.487X.103XNBR	65	104981	LABEL,WARNING
13	163821	LOWER BODY,HEAD VALVE	66	100261	SCREW,SHCS,M4X30
14	163823	SEAL,HEAD VALVE	67	121472	SPACER,PUSHER LATCH
15	163845	SEAL,FRAME/CAP	68	166783	MAGAZINE,PAD PRINT,F33PT
16	851606	O-RING,1.850X.210	69	166778	LATCH,PUSHER
17	163922	ASSEMBLY,PISTON/DRIVER	70	120927	LABEL,SENSOR SMALL (DR)
18	163824	SLEEVE,CYLINDER	71	163912	ASSEMBLY,END CAP
19	175520	SEAL,CHECK	72	163866	ROD,GUIDE
20	163855	RING,CYLINDER SLEEVE	73	120878	SPRING,PUSHER LATCH
21	108718	O-RING,3.484X.139	74	MPW4	WASHER,PWN,M4
22	89673	O-RING,2.550X.103	75	MSB6100-12	SCREW,SBHCS,M6X1.00X12
23	163856	SEAL,END CAP	76	121407	PIN,SPECIAL
24	163843	END CAP,PAINT	77	MHE4070-100	ELASTIC STOP NUT,M4
25	T50118	WASHER,PLAIN	78	163898	PUSHER
26	MSC5080-20	SCREW,SOC HD. CAP M5 X 20	79	115143	SPRING,CONSTANT FORCE
27	166781	SPRING,UPPER TRIP	80	163902	HANDLE,PUSHER
28	116964	LABEL,MAGNESIUM	81	121052	SCREW,SHCS,M4X0.70X25
29	171127	FRAME,OVERMOLD	82	112630	SHIELD,DUST
30	107231	BUMPER,DRIVE	83	112631	SPRING,CLIP
31	MCN-KIT2	KIT,METAL CONNECTOR ATTACHME	84	121071	CLIP,TRIP FOOT
32	163900	ARM,UPPER CONTACT	85	121070	FOOT,TRIP
33	MSC4070-16	SCREW,SHCS,M4X0.7X16	86	163858	PLUG,EXHAUST
34	163903	BUSHING,TRIP COVER	87	164225	ACTUATOR,SMART TRIGGER
35	163924	NOSE,F33PT	88	MSC6100-35	SCREW,SHCS,M6X1.00X35
36	166772	SPRING,CONTACT ARM	89	171342	WASHER,UTILITY HOOK
37	108224	CASTING,HOUSING CONTACT	90	171354	ASSEMBLY,UTILITY HOOK
38	142941	ARM,LOWER CONTACT	91	171338	COVER,TRIP
39	121072	ASSEMBLY,TRIP FOOT	92	UB3811.2	PIN,SPIROL - 5/32X3/4
40	115230	SPRING,HOUSING	93	171340	MOUNT,UTILITY HOOK
41	166777	CASTING,PLUNGER	94	171341	SPRING,UTILITY HOOK
42	MSC8125-30	SCREW,SHCS M8X30	95	171339	HOOK,UTILITY
43	854004	WASHER,RUBBER-7			
44	163877	PAWL			
45	163878	SPRING,CHECK PAWL			
46	149882	PIN,CHECK PAWL			
47	163883	GUIDE,ARM			
48	SEQ7	KIT,SEQUENTIAL TRIP CONVERSION			
49	CNTK4	KIT,CONTACT TRIP CONVERSION			
50	100387	SPRING,COMPRESSION			
51	TVA6	KIT,TRIGGER VALVE			
52	171335	LABEL,WARNING,METAL CONNECTOR			
53	108562	SCREW,TRIGGER PIVOT			